

Scroll down to view entire 7 page brochure



***A Feast with Entertainment to  
start the  
Christmas Season in the Rockies  
- an Annual Museum Fund-Raising Event -***

**2008 Pre-Christmas  
Gala Dinners & Brunch**

**ROYAL ALEXANDRA HALL**  
Canadian Museum of Rail Travel  
**Cranbrook, BC.**

**DINNERS**

- Friday, Nov. 28
- Saturday, Nov. 29

**BRUNCH**

- Sunday, Nov. 30

\* START THE CHRISTMAS SEASON with  
gourmet dining, fine service and great  
entertainment in the graceful ambience of the  
restored Royal Alexandra Hall, a national  
heritage award winner and the centrepiece  
of the museum site and facilities.

This decorative border was found in the Cranbrook Herald newspaper, 1907.



Enjoy an extraordinary evening in the ambience of the 1906 Royal Alexandra Hall.  
- Winner of the 2007 Heritage Canada Gold Medal “Achievment Award” for restoration -

GALA HISTORY AND TABLE LAYOUT

\* After many successful gala dinners from 1983 to 2001 held in the dining car "Argyle" at the former museum site, the museum relocated in 2002; however the new site and facilities were not able to be prepared for a dinner until 2005. From a former maximum of 36 in the dining car, we now seat 120 in the Hall at tables of 8, and some tables of 4. This layout leaves ample circulation space and room for entertainment, including the magnificent **1864 Concert Grand Piano**, which will be used during the Galas.

CORPORATE OR GROUP BOOKINGS

\* Groups or businesses may want to book a table for their staff at a special corporate rate. Or you may want to give a ticket as a gift to someone, or yourself.

ATTIRE

We want our guests to be comfortable, but in order to maintain the ambience of the evening with respect to the historical context of the Royal Alexandra Hall and the era portrayed, we urge attendees to maintain a business attire or, at the minimum, jacket and tie for gentlemen. We also encourage full formal wear or period costumes as this fits well with the evening ambience.

ENTERTAINMENT DURING THE DINNERS (sponsored by Investors Group)

\* Lorraine Butler, a professional vocalist and teacher and a star of the vaudeville stage for many years is the coordinator of (and a participant with) various soloists, duos, trios and quartets and others. Between each course there are short musical interludes to offer variety and excellence in the Spirit of Christmas.

THE MUSEUM'S MAIN ANNUAL FUND-RAISING EVENT

\* Since this is a major fundraising event, a portion of each ticket is a **charitable donation** with an income tax deductible receipt to help the annual operations of the Museum.  
\* The Museum does not have the resources that a large urban centre would have and it does not have the average total government subsidy of between 80% and 90% for operations. The museum must therefore raise 55% of its annual operating budget - a very difficult task. Besides railcar tour ticket and gift shop sales, memberships and other ventures, these Gala Dinners are the Museum's main annual fund-raiser. About 25% of each ticket sold pays for the substantial Gala printing and advertising costs, with the balance (around 15%) going to the Museum

\* **YOUR PURCHASE OF GALA TICKET IS THEREFORE A MAJOR FORM OF FINANCIAL SUPPORT TO THE MUSEUM.**

EVENING GALA DINNER SCHEDULE

Catered by **Heidi's Restaurant** 250-426-7922  
Heidi's has extensive experience in catering many events at the Royal Alexandra Hall since it opened in April, 2004

5:45 pm PRE-DINNER “Champagne Reception”

- \* A traditional social time in the **PALM COURT and RECEPTION HALL**, accompanied by music to begin your evening in the grace and style of the period of 1906.
- \* The no-host bar with beer and wine open until 6:45; opens during dinner again until after the main course.

**COURSE #1** - SAVOURY CANAPES - served 10 minutes before dinner.  
- A GLASS OF CHAMPAGNE - President "Grand Reserve" served any time after arrival.

7:00 pm DINNER

- \* Served in the Royal Alexandra Hall along with **professional entertainment throughout the evening** between the various courses, and piano reception music *sponsored by Investors Group*.
- \* Museum volunteers in period dress will help seat people & serve water to tables.

**COURSE #2** - HOT APPETIZER  
- **Baked Roma Tomatoes** filled with savoury Cous Cous  
- with a glass of APERITIF WINE - **Pinot Grigio** (Sonora Ranch)

**COURSE #3** - SALAD  
- **Grilled Portabello Mushroom & Feta** lightly tossed in a Mediterranean vinaigrette  
- with a top up to your glass of APERITIF WINE

**COURSE #4** - SOUP  
- **Roasted Bell Pepper and Carmlized Garlic Soup** accented by Pesto Crostini

**COURSE #5** - PALATE CLEANSER  
- **Moscato Granite** (a Champagne ice)

***BREAK** - 20 minutes - piano music*

**COURSE #6** - ENTREE  
- **Pork Tenderloin** stuffed with figs and pears on a \*Sauce Provencale\*  
- **accompanied by** herb Gnocchi and roasted vegetables  
- with 2 glasses of DINNER WINE - **Castillo de Almansa** (Spain)

*\*BAR SERVICE closes at end of the Entree*

**COURSE #7** - DESSERT  
- **Honey Baklava** Alla Turca  
- with a glass of DESSERT WINE Concha Y Toro **Sauvignon Blanc "Late Harvest"**

AFTER DINNER RECEPTION

\* held in the **PALM COURT AND RECEPTION HALL** to wind up the evening at your leisure.

**COURSE #8** - FRUIT & CHEESE PLATTERS  
- **Various exotic cheeses with fruit** - enjoy this last burst of flavours.

**COURSE #9** - TEA/COFFEE  
- with **chocolate mint sticks, and Kahlua or Bailey's** in your beverage if you wish.  
- Museum volunteers in period dress will help serve tea/coffee and liquer

ADVANCE TICKETS REQUIRED

FLOOR PLAN & DINNER PRICES ON TICKET ORDER FORM INSERT

- a maximum of 120 per evening with 12 tables of 8 and 6 tables of 4, so early bookings are recommended  
*Brunch details continued over page*



# SUNDAY MORNING GALA BRUNCH



Catered by **Frisco's Restaurant at the Prestige** 250-417-0425  
Frisco's has extensive experience in catering many events at the Royal Alexandra Hall since it opened in April, 2004

**11:00 AM - Brunch Begins** *(one sitting only - doors open at 10:45)*  
\* **Advance tickets are required**, and seating is at tables for 8 or 4 on a first-come, first-serve basis, so early bookings are recommended, particularly for groups.  
\* A Hostess will seat you upon your arrival as per the traditional custom of 1906  
\* The brunch is set up as a buffet in the Reception Hall, and food service will end at 12:00 noon with beverage service and entertainment continuing until 12:30, assisted by museum volunteers dressed in 1912 tea-gowns.  
\* **Period entertainment** will be provided for your enjoyment, *sponsored by Investors Group of Cranbrook.*

### PASTRIES

- \* Croissants \* Danish \* Mini Bagel . . . with butter (or butter substitute) & jam
- \* French Toast \* Grand Marnier flavoured whipped cream \* Maple Syrup

### EGGS - MEAT

- \* Scrambled Eggs \* Eggs Benedict \* Smoked Salmon Benedict
- \* Sausages \* Canadian Back Bacon \* Grilled Tomato

### FRUIT

- \* Melons \* Grapes \* Strawberries \* Blueberries \* Cheese Slices
- \* Vanilla Yogurt \* Chocolate Fountain

### JUICE

- \* Apple \* Orange \* Cranberry

### TEA/COFFEE

- \* Your choice & served at your table

***FLOOR PLAN & PRICE FOR BRUNCH DETAILED ON TICKET ORDER FORM INSERT***



***Brunch in the Royal Alexandra Hall***

Printed by Kootenay Kwik Print - July 08



## Special Notice

### 2008 PRE-CHRISTMAS MUSEUM GALAS TO HONOUR

GARRY ANDERSON, EXECUTIVE DIRECTOR,  
INDUCTION INTO THE *ORDER OF CANADA*

This year, the Galas will celebrate our Executive Director, Garry Anderson's induction into the Order of Canada, in recognition for his long-term work in the Cranbrook Archives, Museum and Landmark Foundation, including the development of the Canadian Museum of Rail Travel as one of the world's great collections of historic passenger trains.

As a long-time associate, colleague or friend of Garry, or as a member of the community who has benefitted from his 32 years of work on behalf of Cranbrook, we invite you to obtain tickets to the 2008 Galas.

Your attendance would be a great tribute to Garry, and we guarantee that you will enjoy a spectacular evening of extra fine dining and wonderful entertainment in the historic elegance of the Museum's *Royal Alexandra Hall* - winner of Heritage Canada's 2007 Achievement Award for restoration.

The annual Gala dinners, held since 1983, are the major annual Museum Fund-Raisers, so your attendance will also help in that important way. We have enclosed a brochure for you, and hope that you can attend.

Sincerely;

A handwritten signature in dark red ink, appearing to read "Corinne Friesen".

Corinne Friesen  
Chair - 2008 Pre-Christmas Gala Dinners Committee  
Canadian Museum of Rail Travel

A handwritten signature in dark red ink, appearing to read "Bob Benisson".

Bob Benisson  
Chair - Board of Directors  
Cranbrook Archives, Museum and Landmark Foundation





CANADIAN MUSEUM OF RAIL TRAVEL - 2008 Pre-Christmas Gala DINNERS and BRUNCH  
ROYAL ALEXANDRA HALL - TABLE LAYOUT PLAN

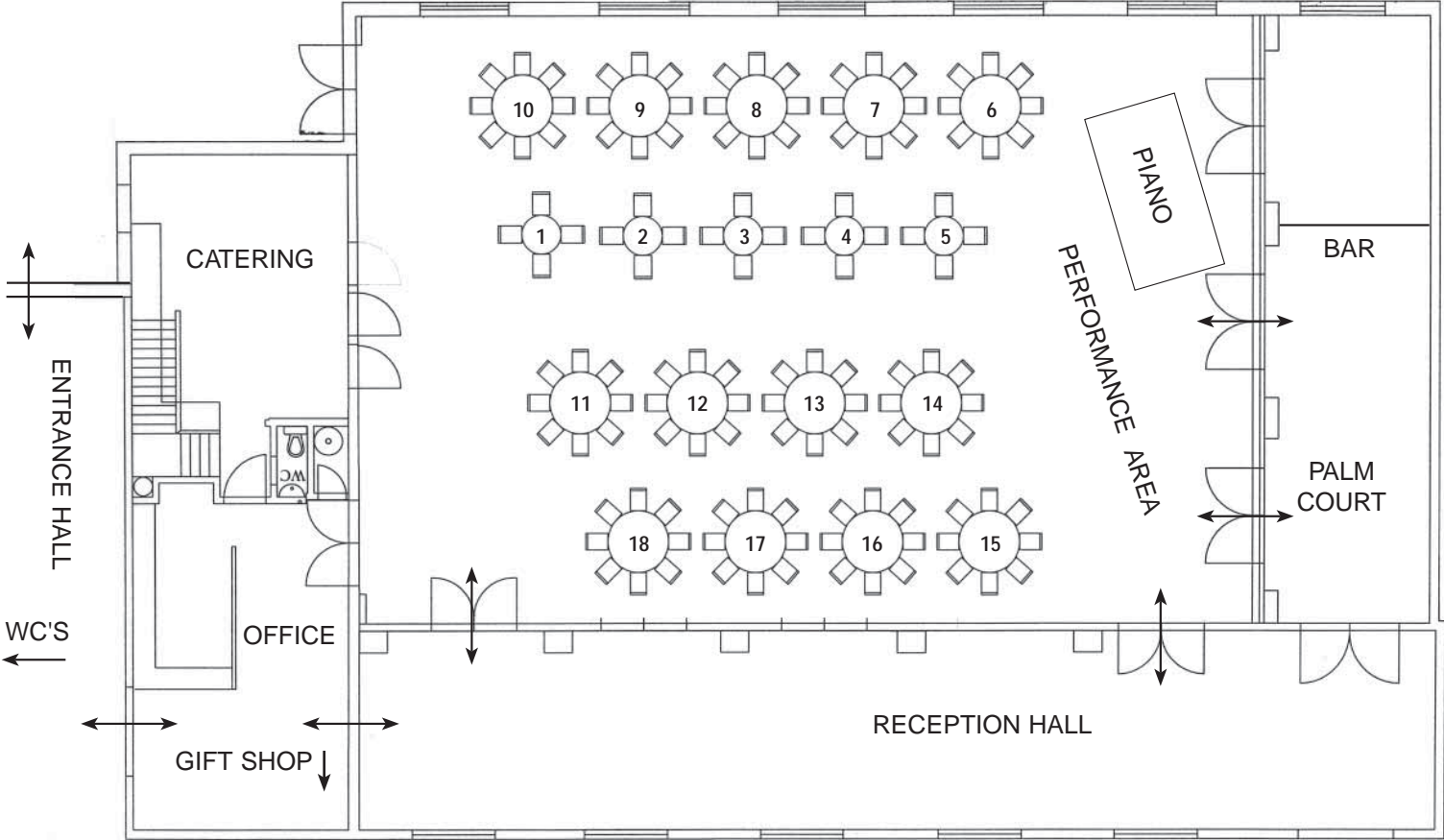

# TICKET ORDER FORM

TYPE OF TICKET	DINNER	DINNER	BRUNCH	TOTAL	DEPOSIT	BALANCE
	FRIDAY	SATURDAY	SUNDAY	COST	25%	( due Sept.30 )
	Nov 28/08	Nov. 29/08	Nov. 30/08		* OPTIONAL	
<b>1) SINGLE TICKETS</b>						
<b>DINNER = \$ 119/person</b> + 1 charitable receipt for \$30 ** <i>Optional 25% deposit = \$29.75</i>	# _____	or	# _____	+	# _____	= \$ _____
<b>BRUNCH = \$ 29.50/person</b> + NO charitable receipt issued	# _____	or	# _____	+	# _____	= \$ _____
<b>2) TABLES FOR 4</b>						
(6 tables for 4 are available)						
<b>DINNER = \$ 460/table</b> + 1 charitable receipt for \$104 ** <i>Optional 25% deposit \$ 115</i>	# _____	or	# _____	+	# _____	= \$ _____
<b>BRUNCH = \$113/table</b> + 1 charitable receipt for \$18	# _____	or	# _____	+	# _____	= \$ _____
<b>3) TABLES FOR 8</b>						
(12 tables for 8 are available)						
<b>DINNER = \$880/table</b> + 1 charitable receipt for \$168 ** <i>Optional 25% deposit \$ 220</i>	# _____	or	# _____	+	# _____	= \$ _____
<b>BRUNCH = \$216/table</b> + charitable receipt for \$26	# _____	or	# _____	+	# _____	= \$ _____
<b>TOTAL DUE</b>				<b>\$ _____</b>		

OPTION - Non-Refundable DEPOSIT (amounts detailed above) \$ \_\_\_\_\_

IF DEPOSIT SENT, the **BALANCE is DUE BY SEPT 30, 2008** \$ \_\_\_\_\_

NAME(s) .....

Address ..... City ..... Prov.....

Postal Code ..... Phone (.....) ..... Email .....

CASH\_\_\_\_\_ CHEQUE \_\_\_\_\_ CREDIT CARD TYPE \_\_\_\_\_ \* Phone in or come in for transaction at Museum

\* EARLY TICKET PURCHASES ARE RECOMMENDED DUE TO GALAS POPULARITY AND LIMITED CAPACITY.

\* SEE THE **ATTACHED TABLE LAYOUT** FOR YOUR LOCATION OF CHOICE. IT IS ADVISED TO PHONE THE MUSEUM TO SEE WHICH PLACES ARE STILL AVAILABLE BEFORE YOU BOOK - PHONE: 250-489-3918 or FAX: 250-489-5744  
EMAIL: mail@trainsdeluxe.com. MAILING ADDRESS: Box 400, Cranbrook, BC., V1C 4H9

\* **25% DEPOSITS** (NON-REFUNDABLE) CAN BE PLACED ON DINNER TICKETS (BUT NOT THE BRUNCH) WITH THE BALANCE DUE SEPT. 30. HOWEVER, THE MUSEUM CANNOT HOLD UNPAID TICKETS AFTER THIS DATE, AND IT RESERVES THE RIGHT TO SELL ANY UNPAID TICKETS WITHOUT REFUNDS.

**See also attachment on Gala Entertainment & other events, and Special Accommodation packages.**

# 2008 Pre-Christmas Gala DINNERS and BRUNCH

CANADIAN MUSEUM OF RAIL TRAVEL - ROYAL ALEXANDRA HALL

## SPECIAL ACCOMMODATION PACKAGES

### THE PRESTIGE ROCKY MOUNTAIN RESORT

**adjacent to the museum**

\* Located conveniently by pathway through "Van Horne Park", this 4 1/2 star hotel opened in 1999 on the Museum Development Zone of the City, and has a railway history context.

\* It works in partnership with the museum in promoting the railway history of Cranbrook and area.

\* Full service: Spa, Pool, Gym, Hair Salon, Dining Room, Lounge and Coffee Shop.

\* The Hotel is offering a **special Gala rate** - Phone 250-417-0444 or 1-800-737-8443, and quote "Museum Gala Dinner"

[www.prestigeinn.com](http://www.prestigeinn.com)  
[Cranbrook@PrestigeHotels.ca](mailto:Cranbrook@PrestigeHotels.ca)



### "CRANBROOK PREMIER RESIDENCE"

**(CPR House) Bed & Breakfast**

\* Located at 117-12th Ave. in the heart of the historic "Baker Hill Residential Heritage Area", and adjacent to the downtown area, this heritage B&B is within a reasonable walking distance of the Railway Museum.

\* **Built in 1900 as the "Railway Superintendant's Home"**, this 4,000 sq. ft. heritage home was beautifully restored and upgraded to modern standards of comfort over 4 years, opening in 2006.

\* CPR House is offering a **special Gala rate** - Phone 250-417-2987 and quote "Museum Gala Dinner"

[www.cprhouse.com](http://www.cprhouse.com)  
[cprhouse@shaw.ca](mailto:cprhouse@shaw.ca)



## ENJOY AN INTRODUCTION TO THE CHRISTMAS SEASON IN CRANBROOK

### GALA ENTERTAINMENT

*The historic 1884 John Broadwood & Sons Concert Grand piano will provide reception music and accompaniment for soloists and other entertainers between the dinner courses and at the Brunch, coordinated by Lorraine Butler, our "Gala Hostess".*

*Enjoy the professional entertainment in the superb acoustics of the Royal Alexandra, SPONSORED BY INVESTORS GROUP*

\* The Piano is available for specialized concert use at the Hall, and is a vintage instrument, with original action and ivories, and finished in rosewood. It has the sound of a mid-19th century grand piano. This historic piano also assists young aspiring musicians to learn from visiting performers, perfect their art through performance on this unique instrument, and provide a more comprehensive music instruction in the region. A variety of other rental uses in the Hall include weddings, luncheons, dinners, dances, meetings, etc.



### OTHER EVENTS IN CRANBROOK AT THIS TIME



#### • SYMPHONY OF THE KOOTENAYS

*"Christmas In The Kootenays"* at the Key City Theatre 426-7006

**Saturday, Nov. 29/08** at 7:30 PM **Sunday, Nov. 30/08** at 2:00 PM

The Symphony, a community choir, student pianists, carols and other seasonal sounds. This Christmas concert and winter celebration is an experience to enjoy. Symphony phone: 250-489-4932

#### • DOWNTOWN LIGHT UP AND SANTA PARADE

**Friday, Nov 28** - 6:00 PM Downtown on Baker St.

#### • ARTRAGEOUS GALLERY

Located at 32A - 11th Ave., S. downtown, the Gallery will be hosting its annual *Christmas Exhibit & Sale*. The exhibit will feature over 60 quality artworks including pottery, jewellery, glasswork and painting in various mediums. All artworks are for sale and may be picked-up at time of purchase. **Friday 11-5 and Saturday 11-3.**